

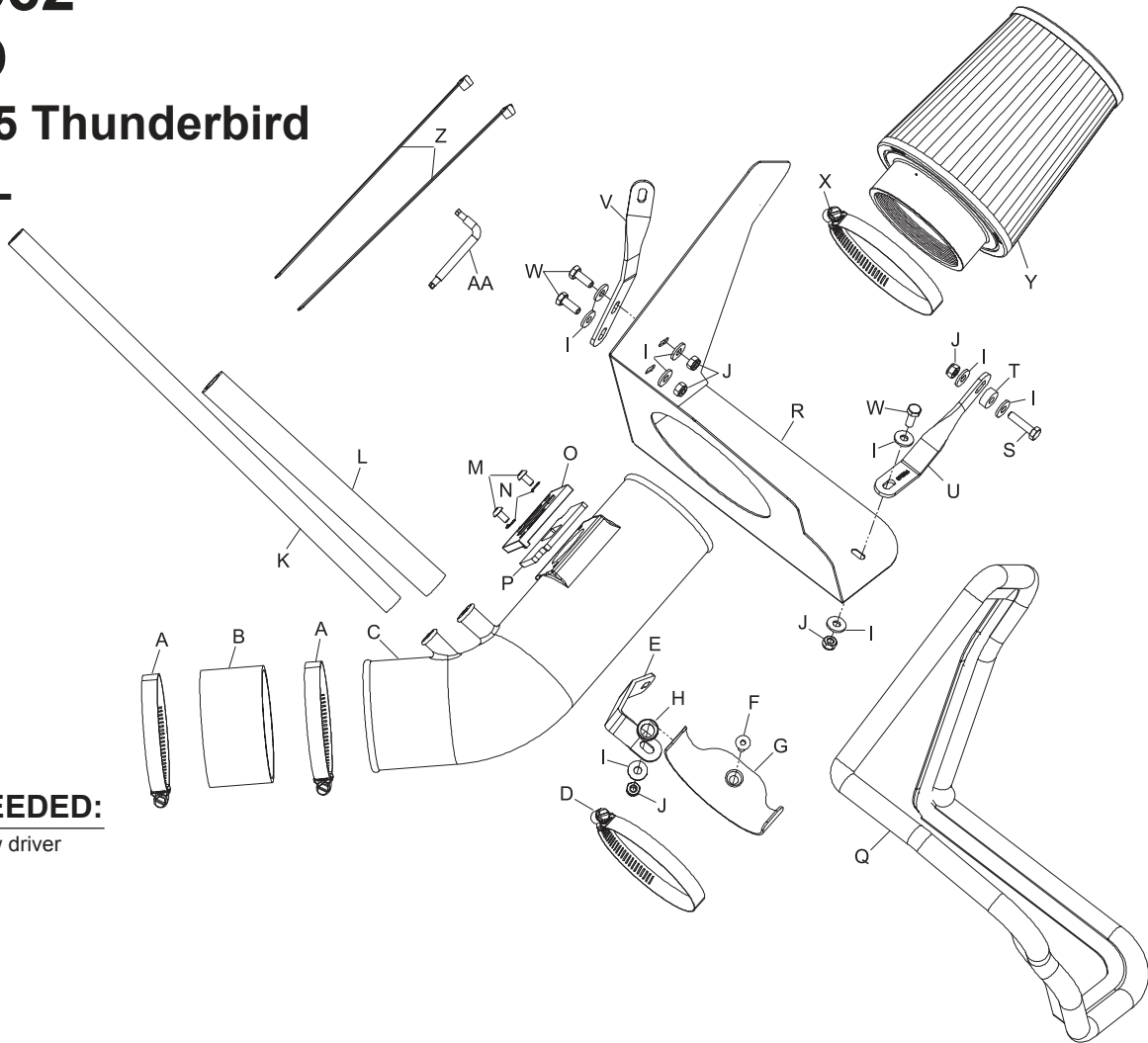

INTAKE SYSTEMS FOR VEHICLES LISTED ARE 50  
STATE LEGAL. SEE KNFILTERS.COM FOR CARB  
STATUS ON EACH PART FOR A SPECIFIC VEHICLE.

# INSTALLATION INSTRUCTIONS

57-2562  
FORD  
2003-05 Thunderbird  
V8-3.9L



### TOOLS NEEDED:

- Flat blade screw driver
- Ratchet
- Extension
- 8mm Socket
- 10mm Socket
- 11mm Socket
- 4mm Allen
- 10mm Wrench

### PARTS LIST:

	Description	Qty.	Part #
A	hose clamp #56	2	08620
B	hose; 3.5" id x 2.0" I	1	08630
C	intake tube (EG)	1	087134
D	hose clamp #52	1	08610
E	bracket "L"	1	010082
F	bolt; 6mm-1.00 x 16mm, f/h/a	1	08376
G	saddle clamp, ss	1	078855
H	washer; cup, black nylon	1	08180
I	washer; 1/4" id x 5/8" od flat	10	08275
J	nut; 6mm nylock	5	07553
K	silicone hose; 3/8" id x 17" I	1	08404
L	silicone hose; 5/8" id x 9.75" I	1	084047
M	bolt; 6mm-1.00 x 16mm, b/h/a	2	07730
N	washer; 1/4" split lock	2	08198
O	adapter #420	1	21515
P	gasket; 3/16" thk poron	1	09069
Q	edge trim 50"	1	102481
R	heat shield	1	07489
S	bolt; 6mm-1.00 x 25mm hex	1	07704
T	spacer; .625" od x .250" id x .250" I	1	06555
U	bracket twist	1	010084
V	bracket	1	010083
W	bolt; 6mm-1.00 x 16mm hex	3	07703
X	hose clamp #60	1	08624
Y	air filter	1	RC-4630
Z	cable ties; black	2	21590
AA	wrench; torx t20	1	69801

**NOTE: FAILURE TO FOLLOW INSTALLATION INSTRUCTIONS AND NOT USING THE PROVIDED HARDWARE MAY DAMAGE THE INTAKE TUBE, THROTTLE BODY AND ENGINE.**

### TO START:

1. Turn off the ignition and disconnect the negative battery cable.  
**NOTE: Disconnecting the negative battery cable erases pre-programmed electronic memories. Write down all memory settings before disconnecting the negative battery cable. Some radios will require an anti-theft code to be entered after the battery is reconnected. The anti-theft code is typically supplied with your owner's manual. In the event your vehicles' anti-theft code cannot be recovered, contact an authorized dealership to obtain your vehicles anti-theft code.**

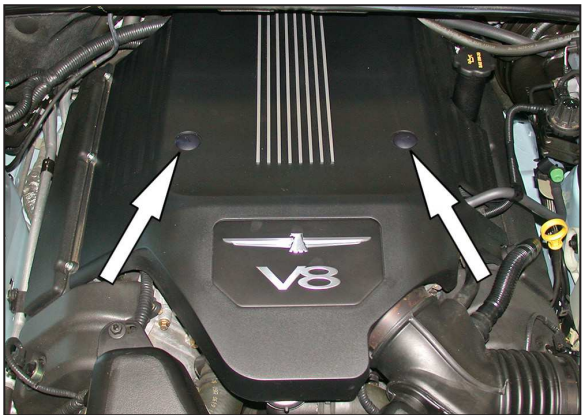

2. Remove the two plastic screws shown securing the engine cover.



3. Pull up on the rear of the engine cover to dislodge from the retaining mounts, and then remove the engine cover from the engine.



4. Pull back the red locking tab on the mass air sensor electrical connection, and then disconnect the mass air sensor electrical connection.



5. Disconnect the evaporative hose from the evaporative valve and cut the two tie wraps securing the hose to the bracket.



6. Depress the locking ring on the crank case vent hose, and then remove the crank case vent hose from the valve cover.



7. Loosen the hose clamps at the throttle body and the factory air box, and then remove the intake tube retaining nut shown.



8. Remove the stock intake tube assembly from the vehicle.

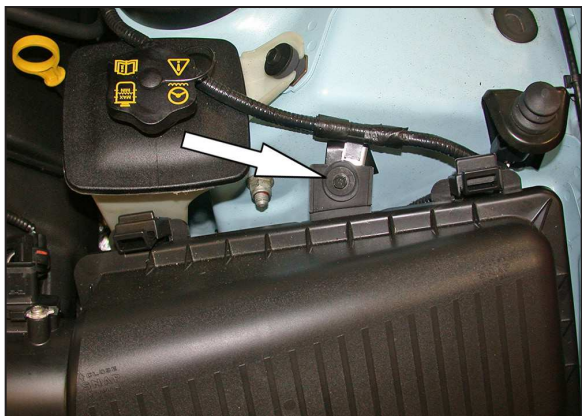

9. Remove the air box retaining bolt shown.





10. Pull up firmly on the air box to dislodge it from the retaining pin, and then remove the air box from the vehicle.  
**NOTE: K&N Engineering, Inc., recommends that customers do not discard factory air intake.**



11. Install the provided edge trim onto the heat shield as shown.



12. Install the heat shield mounting bracket (010083) onto the heat shield as shown with the provided hardware.



13. Install the heat shield into the vehicle and secure the bracket installed in step #12 to the factory air box mount with the factory bolt removed in step #9.



14. Install the provided 6mm bolt through the factory hole in the core support and then install the provided spacer onto the bolt as shown.



15. Install the provided heat shield bracket (010084) onto the bolt installed in step #14, and then fasten the bracket to the heat shield with the provided hardware.  
**NOTE: Use the supplied 1/4" washer as a spacer between the bracket and heat shield.**



16. Install the saddle clamp onto the tube-mounting bracket with the provided hardware as shown.



17. Install the saddle bracket assembly onto the threaded stud on the engine as shown and secure with the provided hardware.



18. Install the provided silicone hose (08630) onto the throttle body and secure with the provided hose clamp.



19. Using the "TORX" wrench provided, remove the mass air sensor from the air box lid as shown.



20. Install the provided gasket onto the K&N® mass air adapter as shown.



21. Using the screws removed in step #19, install the mass air sensor into the K&N® mass air adapter.



22. Install the mass air assembly into the K&N® intake tube and secure with the provided hardware.  
**NOTE: Be sure to install with the opening of the mass air sensor towards the filter end of the tube as shown.**



23. Install the K&N® intake tube assembly into the silicone hose at the throttle body and onto the saddle clamp and secure with the provided hose clamp as shown.



24. Pull firmly on the crank case vent elbow to remove from the vent tube as shown.





25. Install the provided 5/8" silicone hose onto the elbow removed in step #24 as shown.

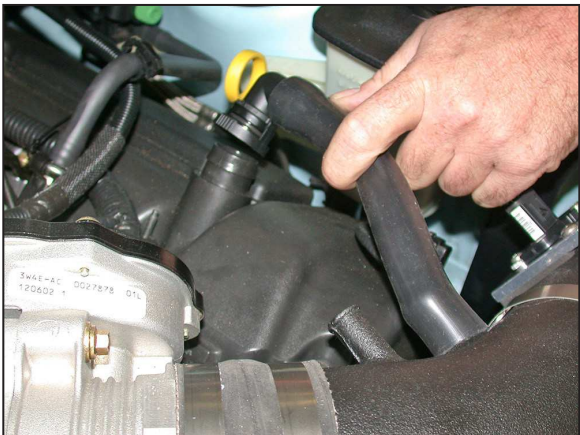

26. Install the vent hose assembly onto the K&N® intake tube and then snap the vent elbow onto the valve cover as shown.



27. Install the supplied 3/8" vent hose onto the K&N® intake tube, and then connect the open end to the evaporative valve as shown.



28. Using the two supplied tie wraps, secure the evaporative hose retaining clip as shown.

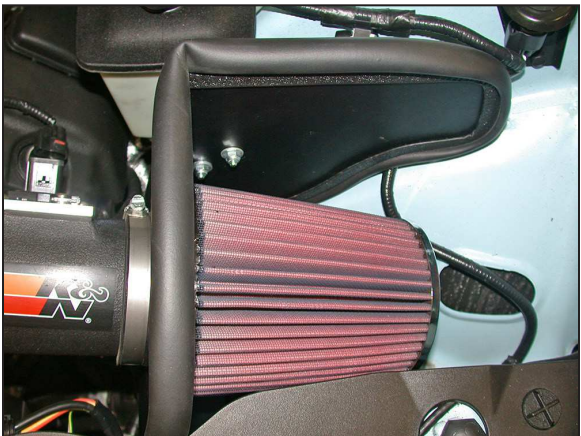

29. Install the K&N® air filter and secure with the provided hose clamp.

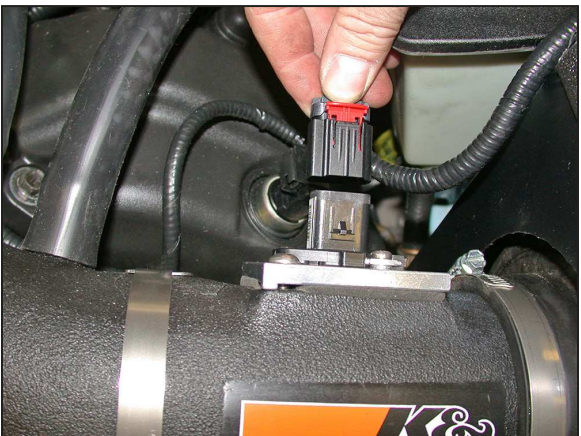

30. Reconnect the mass air sensor electrical connection.



31. Reinstall the engine cover onto the rear retaining clips and then reinstall the retaining clips removed in step #2.



32. Reconnect the vehicle's negative battery cable. Double check to make sure everything is tight and properly positioned before starting the vehicle.

33. The C.A.R.B. exemption sticker, (attached), must be visible under the hood so that an emissions inspector can see it when the vehicle is required to be tested for emissions. California requires testing every two years, other states may vary.

34. It will be necessary for all K&N® high flow intake systems to be checked periodically for realignment, clearance and tightening of all connections. Failure to follow the above instructions or proper maintenance may void warranty.

**ROAD TESTING:**

1. Start the engine with the transmission in neutral or park, and the parking brake engaged. Listen for air leaks or odd noises. For air leaks secure hoses and connections. For odd noises, find cause and repair before proceeding. This kit will function identically to the factory system except for being louder and much more responsive.

2. Test drive the vehicle. Listen for odd noises or rattles and fix as necessary.

3. If road test is fine, you can now enjoy the added power and performance from your kit.

4. K&N Engineering, Inc., requires cleaning the intake system's air filter element every 100,000 miles. When used in dusty or off-road environments, our filters will require cleaning more often. We recommend that you visually inspect your filter once every 25,000 miles to determine if the screen is still visible. When the screen is no longer visible some place on the filter element, it is time to clean it. To clean and re-oil, purchase our filter Recharger® service kit, part number 99-5050 or 99-5000 and follow the easy instructions.

**INTAKE SYSTEMS FOR VEHICLES LISTED ARE 50 STATE LEGAL. SEE KNFILTERS.COM FOR CARB STATUS ON EACH PART FOR A SPECIFIC VEHICLE.**