

## INSTALLATION INSTRUCTIONS

### 57-3039

### CHEVROLET/GMC

### 1996-98 SILVERADO/SIERRA

### V6-4.3L VORTEC

NOTE: This kit was not designed to fit vehicles with a body lift.

#### TOOLS NEEDED:

Ratchet  
Extension  
13mm Socket  
10mm Socket  
8mm Socket  
7/32" Socket  
7/16" Wrench  
3/8" Wrench  
10mm Wrench  
5mm Allen Wrench  
5/32" Allen Wrench  
1/8" Allen Wrench  
Flat Blade Screwdriver

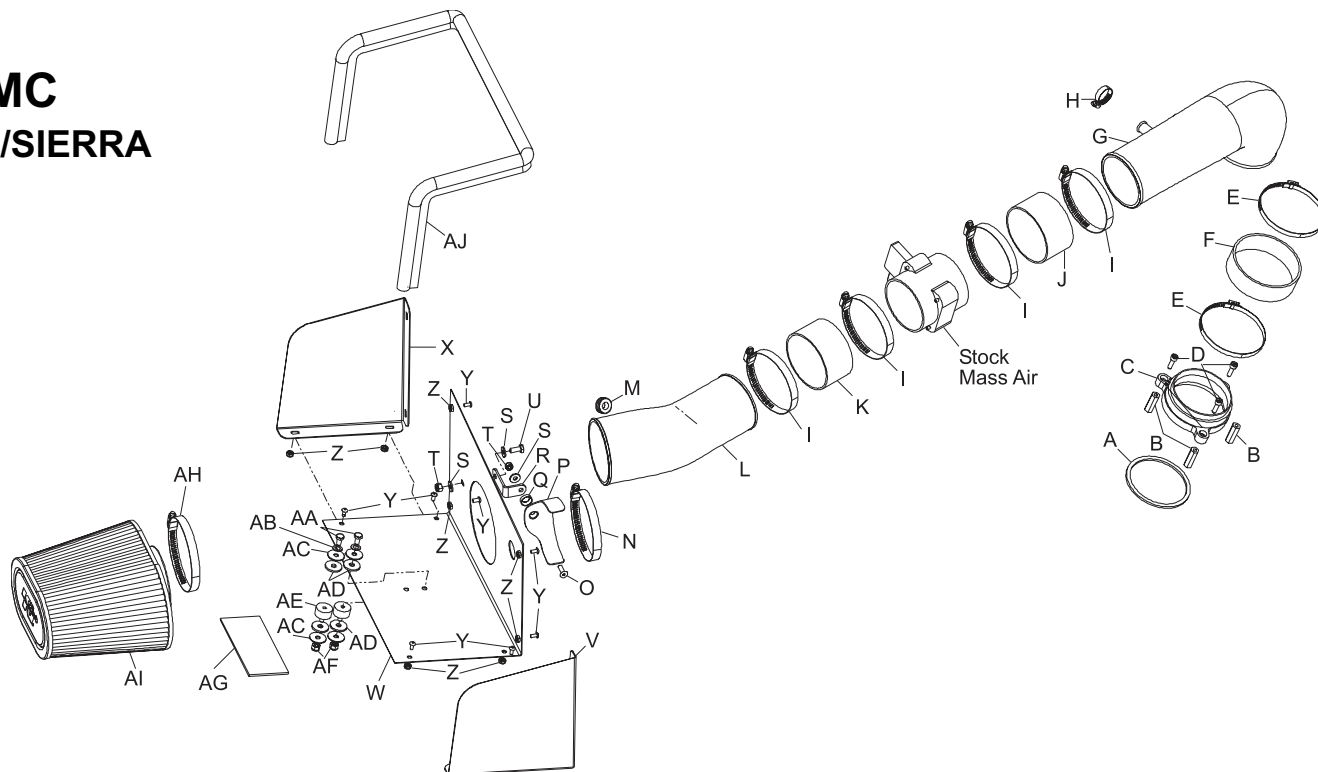

#### PARTS LIST:

Desc.	Qty.	Part#	Desc.	Qty.	Part#	Desc.	Qty.	Part#
A gasket; 3-9/16" id neoprene	1	09766	J hose; 3.5"x2.5" humped	1	08699	S washer; 1/4" x 5/8" flat	3	08275
B nut; coupling	3	08254	K hose; 3.5" x 2.0, silicone	1	08630	T nut; 6mm nylock	2	07553
C adapter; throttle body	1	08799	L intake tube (DT)	1	087115	U bolt; 6mm-1.00 x 16mm hex	1	07703
D bolt; 6mm-1.00 x 16mm allen	3	07818	M grommet; 1" od, 1/2" id, 1/2" thk	1	08064	V heat shield (B)	1	07409
E hose clamp #64 midi	2	08650	N hose clamp #60	1	08628	W heat shield (A)	1	07408
F hose; 4.0" x 1.25", silicone	1	08712	O bolt; 6mm-1.00x20mm f/h/a, ss	1	08376	X heat shield (C)	1	07410
G intake tube (DS)	1	087114	P saddle bracket	1	078855	Y bolt; 10-32x3/8" ss btn head	8	08387
H hose clamp #10 mini	1	08411	Q washer; conical, nylon, black	1	08180	Z nut; 10-32, ss, nylock	8	08253
I hose clamp #56	4	08620	R bracket	1	07078	AA bolt; 1/4-20, btn head	2	07706
						AB washer; 1/4" split lock	2	08198
						AC washer; 1" od x 1/4" fender	4	08160
						AD washer; 1"x.300x.100 rubber	4	21685
						AE stud; 1/4-20 m/f rubber mntd	2	08011
						AF nut; 1/4-20 nylock	2	07517
						AG gasket; 1/8"x5-1/2" x 2-1/2"	1	09331
						AH hose clamp # 64	1	08648
						AI air filter	1	RF-1040
						AJ edge trim 42"L	1	102499

**NOTE: FAILURE TO FOLLOW INSTALLATION INSTRUCTIONS AND NOT USING THE PROVIDED HARDWARE MAY DAMAGE THE INTAKE TUBE, THROTTLE BODY, AND ENGINE.**

#### TO START:

1. Turn the ignition OFF and disconnect the vehicle's negative battery cable.



2. Loosen and remove the tall wing nut on the throttle body.



3. Release the over center clamps and remove the air box lid.



4. Disconnect the crank case vent hose from the factory air intake tube.



5. Disconnect the air temperature sensor electrical connection.



6. Disconnect the mass air sensor electrical connection



7. Lift and remove the complete air intake system.



8. Remove the lower air box assembly.  
**NOTE: K&N Engineering, Inc., recommends that customers do not discard factory air intake.**



9. Using a 13mm socket, remove the lower air box bracket from the inner fender.



10. Remove the stock intake tube mounting bolt from the throttle body.



11. Using a 5/16" wrench, remove the factory bolt from the stand off and reinstall the factory bolt in its original location.



12. Using a 10mm socket remove the wire harness retaining clip nut at the front of the throttle body.



13. Using a flat blade screwdriver, loosen the hose clamps and remove the mass air sensor from the stock intake tube.



14. Remove the air temperature sensor from the factory intake tube.



15. Hand tighten the three provided coupling nuts on the original throttle body studs.



16. Install the neoprene gasket provided onto the throttle body flange.

# INSTALLATION INSTRUCTIONS



17. Install the throttle body adapter and hand start the three 6mm allen bolts.

18. Using a 7/16" wrench, snug the three coupling nuts and tighten the three 6mm bolts using a 5mm allen wrench.



19. Assemble the heat shield using the hardware provided as shown.



20. Install the rubber mounted studs onto the bottom of the heat shield using the hardware provided.



21. Assemble the saddle bracket onto the "L" bracket as shown with the provided hardware as shown.



22. Install the saddle bracket assembly to the heat shield using the hardware provided.



23. Install the trim seal onto the heat shield. **NOTE: Some cutting and trimming will be necessary for best fit.**



24. Install the heat shield assembly and secure to the inner fender using the hardware provided.



25. Apply the gasket provided onto the heat shield to cover the exposed bolts.



26. Install the silicone hump hose (08699) onto the secondary intake tube and secure with the hose clamp as shown.



27. Install silicone hose (08712) onto the throttle body adapter and secure with the provided hose clamp as shown.



28. Install the intake tube onto the silicone hose at the throttle body.

**NOTE: Do not completely tighten the hose clamp securing the intake tube at this time.**



29. Install the crank case vent onto the secondary intake tube and secure with the provided hardware.



30. Install the silicone hose (08630) onto the mass air sensor inlet side.

**NOTE: An arrow on the side of the mass air sensor points towards the outlet side of the sensor.**



31. Install the provided grommet into the primary intake tube as shown.



32. Install the air temp sensor into the primary intake tube as shown.



33. Install the primary intake tube assembly onto the mass air sensor assembly and attach with the provided hose clamp as shown.

**NOTE: Do not completely tighten hose clamp at this time.**



34. Install the primary tube/mass air assembly onto the secondary intake tube and heat shield saddle clamp and secure with the provided hose clamps.

**NOTE: Do not completely tighten the hose clamps at this time.**



35. Install the K&N® air filter element and secure with the provided hose clamp.



36. Reconnect the mass air sensor and air temp sensor electrical connections.



37. Reconnect the vehicle's negative battery cable. Double check to make sure everything is tight and properly positioned before starting the vehicle.

38. The C.A.R.B. exemption sticker, (attached), must be visible under the hood so that an emissions inspector can see it when the vehicle is required to be tested for emissions. California requires testing every two years, other states may vary.

39. **NOTE:** Most General Motors vehicles have the Vehicle Emissions Certification Information (VECI) label affixed to the air filter box. In order to be compliant with California emissions laws, the label **MUST** remain in the engine compartment. If the Vehicle Emission Control Information label is removed during modification, a new replacement label must be obtained and installed in a readily visible position in the engine compartment. The label shall not be affixed to any equipment which is easily detached from the vehicle. We recommend that the label is affixed to the underside of the hood adjacent to the hood latch. The label is Vehicle Identification Number dependent and can be ordered from the vehicle dealership. In order to receive the proper decal please bring your VIN with you. Failure to have the VECI under the hood may result in failure of a pre-registration smog test.

40. It will be necessary for all K&N® high flow intake system to be checked periodically for realignment, clearance and tightening of all connections. Failure to follow the above instructions or proper maintenance may void warranty.

## ROAD TESTING:

1. Start the engine with the transmission in neutral or park, and the parking brake engaged. Listen for air leaks or odd noises. For air leaks secure hoses and connections. For odd noises, find cause and repair before proceeding. This kit will function identically to the factory system except for being louder and much more responsive.

2. Test drive the vehicle. Listen for odd noises or rattles and fix as necessary.

3. If road test is fine, you can now enjoy the added power and performance from your kit.

4. K&N Engineering, Inc., suggests checking the air filter element periodically for excessive dirt build-up. When the element becomes covered in dirt (or once a year), service it according to the instructions on the Recharger service kit, part number 99-5050 or 99-5000.

**50-STATE STREET LEGAL**  
**K&N CARB EXEMPT K&N**

\*FREE K&N DECAL To register your warranty, please see us online at [knfilters.com/register](http://knfilters.com/register). FREE K&N DECAL\*