



INSTALLATION INSTRUCTIONS

Cat-Back Exhaust

MAKE: Lexus
 MODEL: IS200t
 YEAR: 2016-2017
 ENGINE: L4-2.0L

49-36059-B
 49-36059-C
 49-36059-L
 49-36059-P

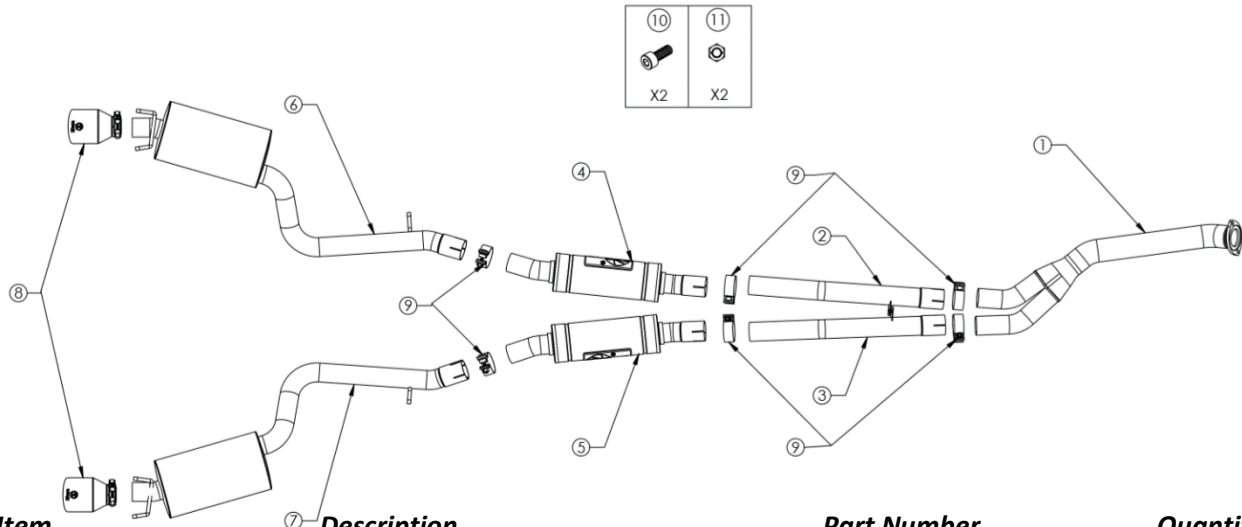

Item	Description	Part Number	Quantity
1	Front Pipe	05-245284	1
2	Driver Side Mid-Pipe	05-245285	1
3	Passenger Side Mid-Pipe	05-245286	1
4	Driver Side Muffler Assembly	05-245287	1
5	Passenger Side Muffler Assembly	05-245288	1
6	Driver Side Tail-Pipe	05-245289	1
7	Passenger Side Tail-Pipe	05-245290	1
8	EXH Tip 2-1/2 In x 4-1/2 Out x 7L Bolt-On Blk	49T25454-B07	2
8	EXH Tip 2-1/2 In x 4-1/2 Out x 7L Bolt-On CF	49T25454-C07	2
8	EXH Tip 2-1/2 In x 4-1/2 Out x 7L Bolt-On Blue	49T25454-L07	2
8	EXH Tip 2-1/2 In x 4-1/2 Out x 7L Bolt-On Pol	49T25454-P07	2
9	Clamp, Band: 2-1/2"	05-41061	6
10	Screw, Socket Head Cap: M8 x 1.25 x 20	03-50341	2
11	Nut, Hex Oval Lock: M8 x 1.25	05-46057	2

aFe POWER recommends professional installation on this product. Thoroughly inspect the aFe POWER exhaust system to make sure there is no damage from shipping (if damage is noted, immediately contact aFe POWER customer service). Allow time for your vehicle to cool down prior to installation. When working on your vehicle proceed with caution. Wear protective safety equipment; eye goggles and gloves to ensure a safe installation.

Install band clamps to proper torque specifications of 40-45 ft-lb.





INSTALLATION INSTRUCTIONS

MAKE: Lexus
MODEL: IS200t
YEAR: 2016-2017
ENGINE: L4-2.0L

Cat-Back Exhaust

49-36059-B
49-36059-C
49-36059-L
49-36059-P

1. **(Read instructions prior to installation.)** It is recommended to not fully tighten the exhaust until it has been fully installed. Leave loose for adjustability.
2. Secure vehicle on jack stands (refer to your manual for specified jack stand positions).
3. For faster installation, spread out the parts of the exhaust alongside your vehicle as shown in the diagram above.
4. Secure the stock exhaust with jack/stands.
5. Remove the (x2) Bolts and gasket from the O.E. Front Pipe. Retain the O.E. gasket and hardware for installation.
6. Remove the crossmember and retain the O.E. hardware for reinstallation.
7. Remove the (x4) Bolts from rear section of the O.E. Exhaust.
8. Remove Hangers from Rubber Mount Isolators in the front section and rear section of the O.E. exhaust. Remove O.E. exhaust from vehicle.
9. Install Takeda Front Pipe using the O.E. Gasket and hardware.
10. Slide Takeda Driver Side Mid-Pipe into the Takeda Front Pipe and secure with provided 2-1/2" Band Clamp.
11. Slide Takeda Passenger Side Mid-Pipe into the Takeda Front Pipe and secure with provided 2-1/2" Band Clamp. Secure the Takeda Driver Side Mid-Pipe and the Takeda Passenger Side Mid-Pipe together using the provided nuts and bolts.
12. Slide Takeda Driver Side Muffler Assembly into the Takeda Driver Side Mid-Pipe and secure with the provided 2-1/2" Band Clamp.
13. Slide Takeda Passenger Side Muffler Assembly into the Takeda Passenger Side Mid-Pipe and secure with the provided 2-1/2" Band Clamp.
14. Slide Takeda Driver Side Tail-Pipe into the Takeda Driver Side Muffler Assembly and secure with the provided 2-1/2" Band Clamp. Install hangers into O.E. Rubber Mount Isolators.
15. Slide Takeda Passenger Side Tail-Pipe into the Takeda Passenger Side Muffler Assembly and secure with the provided 2-1/2" Band Clamp. Install hangers into O.E. Rubber Mount Isolators.
16. Install Takeda Exhaust tips.
17. Reinstall the crossmember using the O.E. hardware that was retained.
18. Ensure that all the components of the TAKEDA exhaust system are aligned and are at a safe clearance from all wires, hoses, brake lines, body parts, and tires.
19. Start from the front of the TAKEDA exhaust system and evenly tighten all clamps and fasteners.
20. Start the vehicle and check for any leaks. If any leaks are found, determine cause and repair as necessary.
21. Remove vehicle from jacks stands.
22. It is recommended to re-tighten all clamps and hardware after 50-100 miles.