



DINAN

**REAR SHOCK MOUNT KIT
INSTALLATION NOTES**

PART NUMBER DI10-0008

| | | |
|--------------|---------|----------------------------------|
| APPLICATION: | 2006 | 325i, 330i (E90) |
| | 2007-12 | 328i, 335i/xi/is (E90, E92, E93) |
| | 2008-12 | 135i (E82) |
| | 2011-12 | 1-M Coupe (E82) |
| | 2008-12 | M3 (E90, E92, E93; non-EDC only) |

Congratulations for being selective enough to use a Dinan Engineering rear shock mount. This mount allows for an additional 10mm of suspension travel, which improves vehicle handling and ride comfort.

We have spent many hours developing our suspension components to assure that you will receive maximum performance and durability with minimum difficulty in installation. Please take the time to read these notes and call us if you have any difficulties during the installation.

NOTE: This kit is designed to work in conjunction with Dinan, BMW, or other rear shocks, which have 10mm threads at the top of the shock shaft, which is the stock size. DO NOT use this kit with Dinan DI40-0946 rear shocks that have an external adjustment, as these shocks have 12mm threads on the shock shaft. Do not use this kit with M3 EDC shocks, as these have 14mm threads on the shock shaft.

- DO NOT WORK ON VEHICLES SUPPORTED BY A JACK ONLY. USE SECURE JACK STANDS!
- Some of the existing upper shock mount components must be replaced with corresponding parts included in this kit. Study the assembly diagram carefully to determine which components are used, and the order in which they are assembled.
- Remember to install the bumpstop & cover before assembling upper shock mount!

PARTS LIST

| Qty | Part # | Description |
|-----|-----------|-----------------------|
| 2 | DI12-0008 | Shock Bushing; Lower |
| 2 | DI12-0009 | Shock Bushing; Upper |
| 2 | DI12-0010 | Spacer |
| 2 | DI12-0011 | Sleeve (10mm I.D.) |
| 2 | D671-0134 | M10 x 1.0P Nylock Nut |
| 2 | M10 FLAT | 10mm Washer |

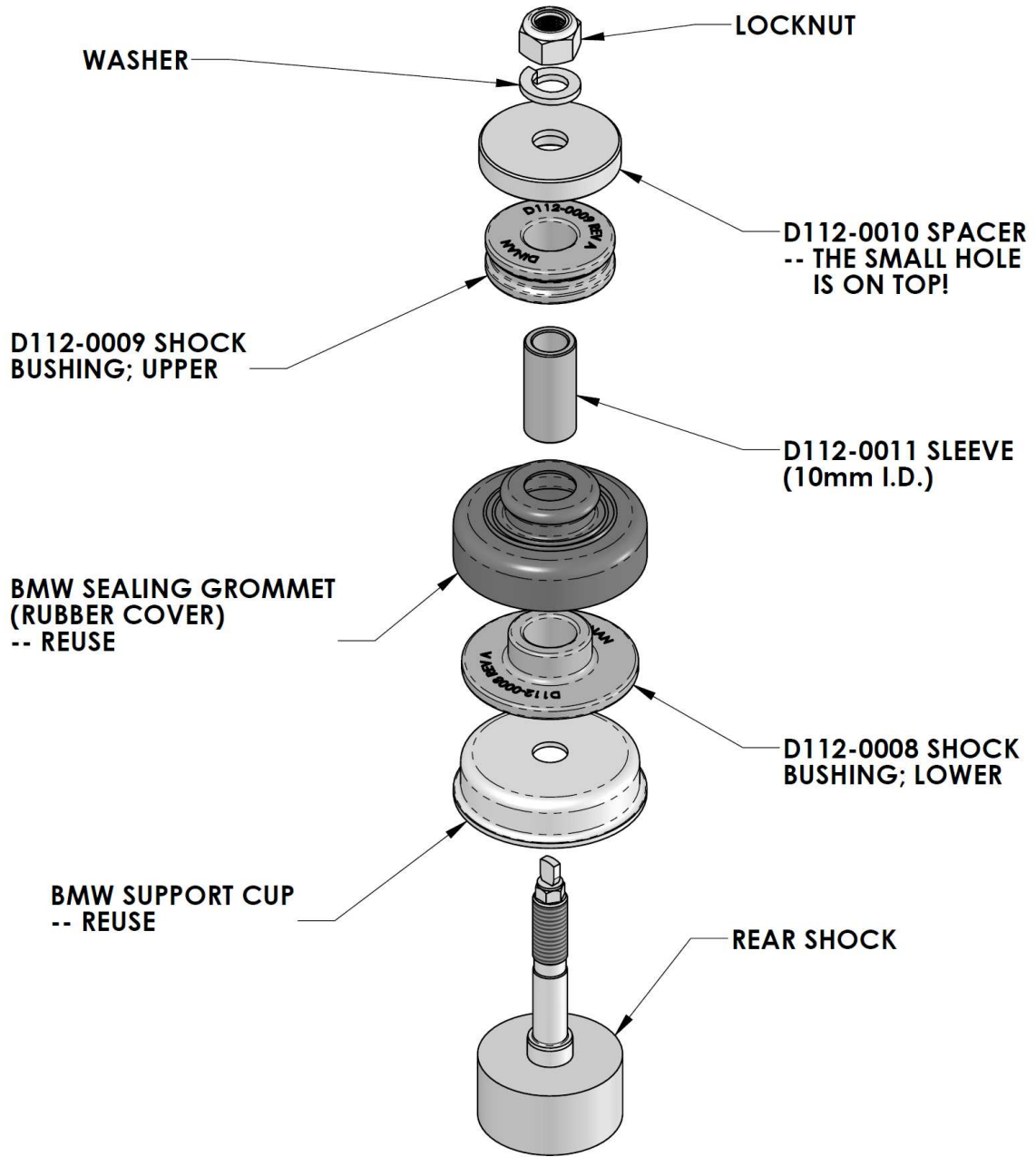

BUMPSTOP NOT SHOWN FOR CLARITY